

### Features:

- Roof or Wall Application
- Horizontal or Vertical Installation
- Applied over solid substrate or open framing
- 2 piece concealed clip designed for thermal movement
- Can be curved to a minimum radius of 100"
- Field applied sealant - ensures weather tightness

### Panel Lengths:

- Minimum 5' up to 50'
- Field forming available for panels over 50'
- 1.5" Rib Height, 12" & 20" coverage standard (16" special order)

### Panel Depth:

- 1.5" seam depth, (system depth is 2.0" with clip)

### Product Options:

- Finishes: Kynar 500 ( PVFD) Colors and Acrylic Coated Galvalume
- Available Gauges: 24 ga Standard; 22 ga Optional
- Also available in 20 oz Copper, 0.040 Aluminum
- Mechanically seamed integral side lap seam
- Single or double lock; UL rated in either seam type
- Striated surface standard
- Oil Canning is NOT a cause for rejection
- Weathertight warranty may be available, inquire for details

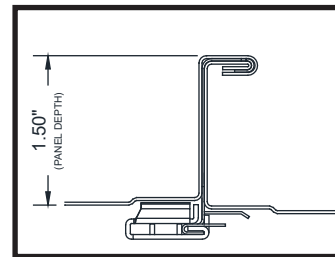

OPTION MS150C @ 90°

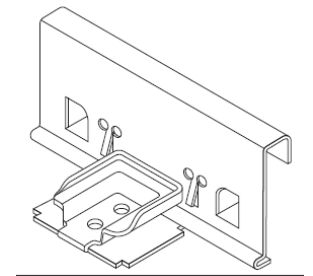

MS150C PANEL CLIP

### Clarifications:

- All panels will be supplied with striations unless specified otherwise, in writing by purchaser.
- Rollfab utilizes top quality materials specifically designed for rollforming applications, which are tension leveled to help minimize oil canning. Oil canning is naturally inherent in sheet metal and is not grounds for rejection.
- Kynar 500 is a registered trademark of Elf Atochem North America Inc.
- Galvalume is a registered trademark of BEIC International, Inc.

### Testing:

- UL-263 Fire Resistance Rating
- UL-790 Class A Fire Resistance
- UL-2218 Class 4 Impact Resistant
- UL-580 Class 90 Wind Uplift, Construction no. 588, 589, 603, 604 & 605
- Florida Building Code approved 8629.1
- Dade County Florida PA-125 approval
- Miami Dade County TAS 100-95 & TAS 125-03/UL1897 approved, no. 05-1122.13
- Dade County Submersion test PA-114 (FM 4471) approved
- ASTM E-330 Structural
- ASTM E-E1646-95 Water Infiltration
- ASTM E-E1680-95 Air Filtration

# MS-150C Mechanical Standing Seam Panel

Profile	ASTM E-283/1680 Air Infiltration		ASTM E-331/1646 Water Penetration	
	Pressure Differential	Leakage Rate	Pressure Differential	Leakage Rate
24 Gauge-16" Wide	6.24 PSF	.006 CFM/sq. ft.	6.24 PSF	None
	12.0 PSF	.000 CFM/sq. ft.	12.0 PSF	None
	15.0 PSF	.000 CFM/sq. ft.	15.0 PSF	None

### LOAD TABLE OVER 15/32" PLYWOOD

Buildings having a Roof Mean Height  $\leq 20'-0"$ ; Roof Slope:  $3"/12 - 12"/12"$   
 Wind speeds 120-150 mph, Exp. C, 1=1.0, based on Florida Bldg. Code 2004

1.5" 24 Ga. Mechanical Lock, 16" Wide, Clip Spacing						
Zone	Fastener	Substrate	Wind Speed Zone			
			120	130	140	150
			On Center Spacing	On Center Spacing	On Center Spacing	On Center Spacing
Zone 1	(2) #12-11x1"	15/32" CDX Plywood	24"	24"	24"	24"
Zone 2	(2) #12-11x1"	15/32" CDX Plywood	24"	6"	6"	6"
Zone 3	(2) #12-11x1"	15/32" CDX Plywood	6"	6"	6"	6"

- PANEL DESCRIPTION: 1.5" Mechanical Lock, Min. 24 Ga. MSG coated steel, 16" max width double lock seam
- PANEL FASTENER: (2) #12-11 x 1" Type A Pancake Head per clip
- PANEL CLIP: 1500SC Floating Clip
- MAXIMUM ALLOWABLE PANEL UPLIFT PRESSURE: 59.75 PSF @ 24" O.C., 123.5 PSF @ 6" O.C. Pressure based on UL 580/UL 1897 Testing by Force Engineering , Test Report #72-0313T-06A-C
- PLYWOOD DECKING: Min. 15/32" Thick, APA Rated Plywood, Grade C-D, Plywood. Must be designed in accordance with F.B.C. 2004

- ◆ Curves standing seam panels in a convex manner in heights of 1.5 inch.
- ◆ The Schleich panel-curving machine is used for arch bending (convex) of metal shapes for roofing dormers and arched or vaulted roofs.

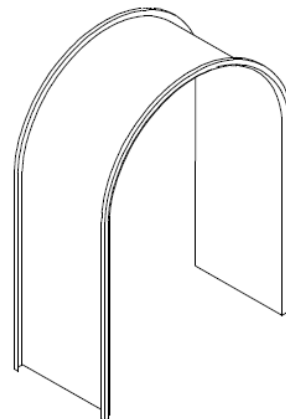
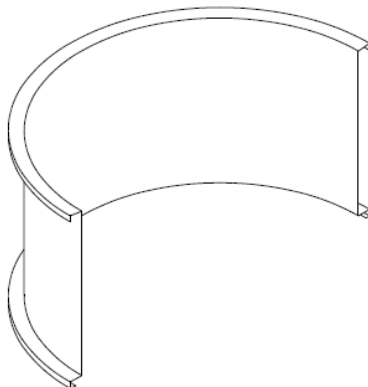

- ◆ Curves U-panels in a convex manner in heights of 1.5 inch.
- ◆ Can curve panels into an elliptical shape.