

**Features:**

- Wall or Soffit Application
- Vertical, Horizontal, or Diagonal Installation
- Applied over solid substrate with a proper underlayment
- Concealed clip attachment designed for thermal movement

**Panel Lengths:**

Minimum 24"  
Maximum length panel 20'-0" (limited to 22ga max. thickness)

**Panel Depth:**

1 1/2" Rib height

**Panel Coverage:**

12"  
(Custom panel widths available upon request)

**Material Options:**

Available gauges:  
24ga or 22ga standard (20'-0" max length)  
0.032 - 0.050 Aluminum, 16 or 20oz Copper, and 0.8mm or 1mm Zinc

**Finish Options:**

ProFinish 500 (PVDF) Colors & Acrylic  
Coated Galvalume®  
(Other specialty finishes available, please inquire an RMP sales rep.)

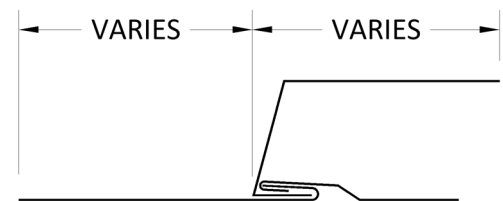

Panel engagement detail

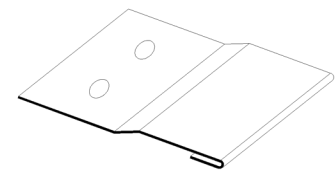

**Panel clips**

- 2" long
- (1) or (2) 3/32" holes
- Galvanized or Stainless Steel

Galvalume® is a registered trademark of BEIC International, Inc.