

MOSAIC

— PLANKS & BATTENS

Batten Installation Guide

 Lumabuilt





**MOSAIC BATTENS ARE FOR
DECORATIVE PURPOSES ONLY,
THEY ARE NOT TO BE USED FOR
STRUCTURAL SUPPORT, BRACING,
OR SUSPENSION OF OBJECTS.**

The installation methods and guidelines outlined in this document have been calculated for the following building substrates:

- 18 Gauge Steel
- 1/2" & 3/4" Plywood

IMPORTANT

The installation methods outlined in this guide are intended to provide general information and recommended procedures for installing the Mosaic Batten system. These instructions are designed to assist experienced installers by illustrating typical installation techniques and best practices.

This guide does not address every possible condition, application, or site-specific requirement. It is the responsibility of the installer, contractor, and/or project team to ensure that all installations comply with applicable local building codes, regulations, and safety standards for the jurisdiction in which the product is being installed.

Lumabuilt does not install the product and has no control over jobsite conditions or installation practices. As such, Lumabuilt assumes no responsibility or liability for improper installation, failure to follow these guidelines, or personal injury resulting from incorrect use or installation of the product. Failure to adhere to Lumabuilt's recommended installation procedures may result in product failure and may void applicable warranties.

These instructions are intended for qualified professionals familiar with architectural battens and standard construction practices. If project-specific conditions require clarification or deviation from these guidelines, please contact Lumabuilt prior to installation for technical support.

SYSTEM COMPONENTS

SOLID BATTENS

Mosaic Solid Battens are extruded aluminum profiles available in multiple sizes. They are typically installed using exposed bracket systems to provide secure attachment and consistent alignment.

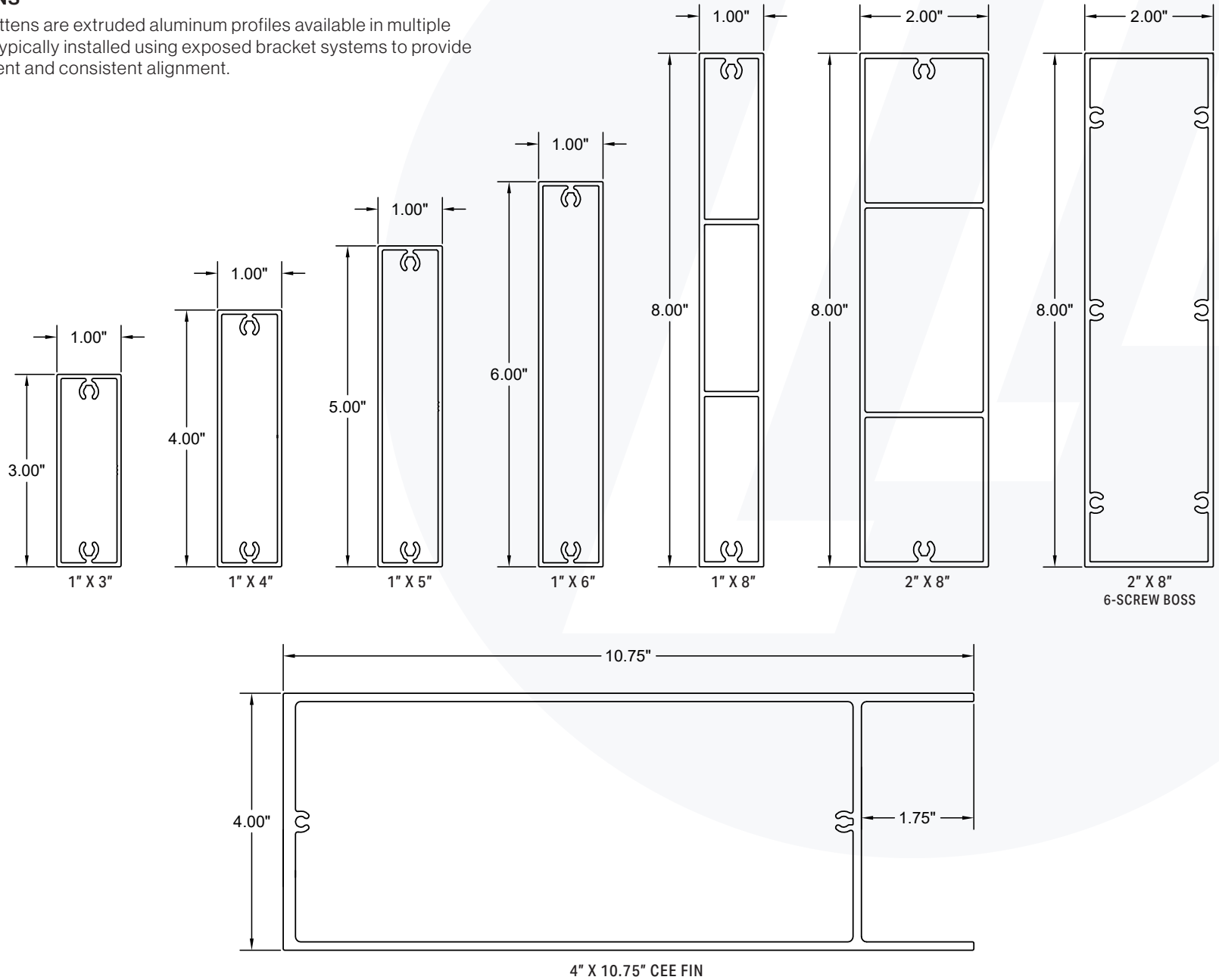

SYSTEM COMPONENTS

2" BATTEN ASSEMBLIES

The 2" Batten Assembly consists of a 2" base profile with snap-on caps available in 2", 3", 4", 6", and 8" heights, forming finished profiles from 2" x 2" to 2" x 8". The base supports attachment, while the cap encloses the remaining sides to create a complete batten profile. This modular configuration allows depth variation while maintaining consistent alignment and secure installation.

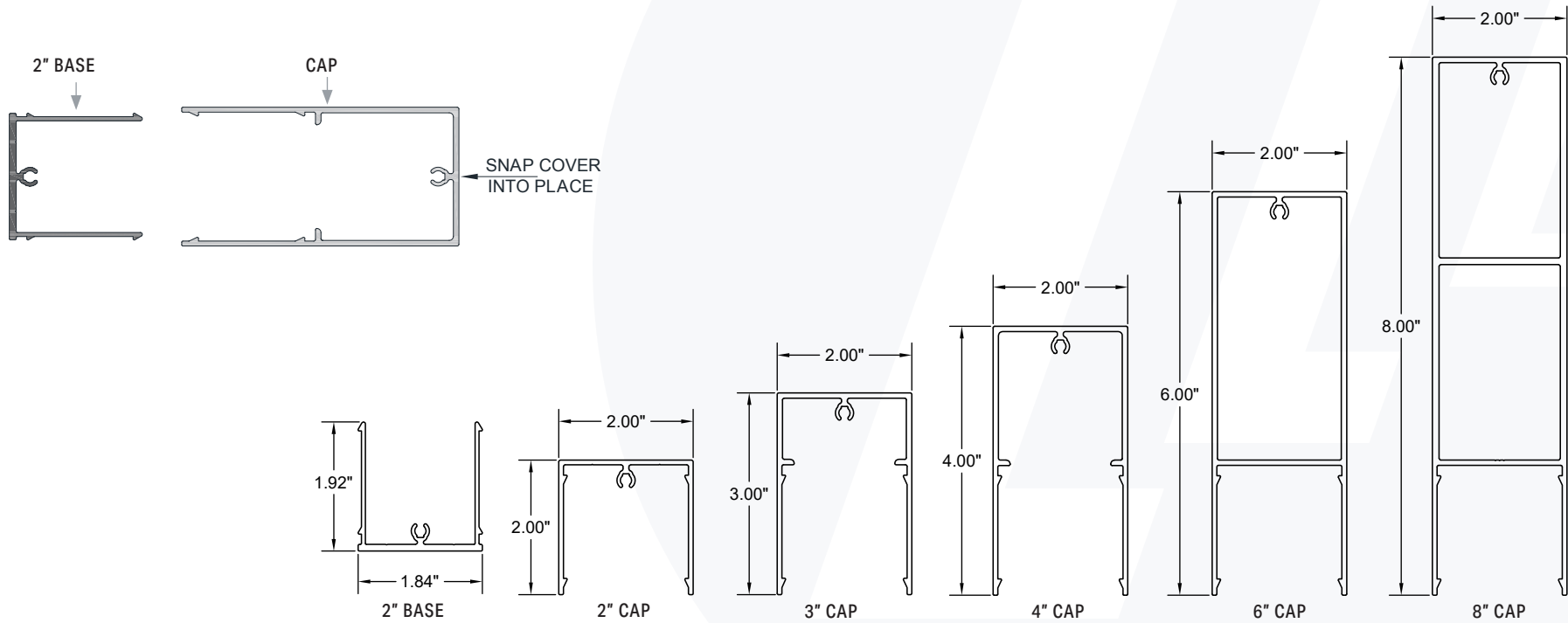

OTHER BATTEN ASSEMBLY SIZES

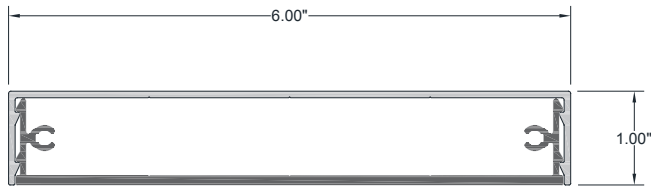

6" X 1" BATTEN ASSEMBLY

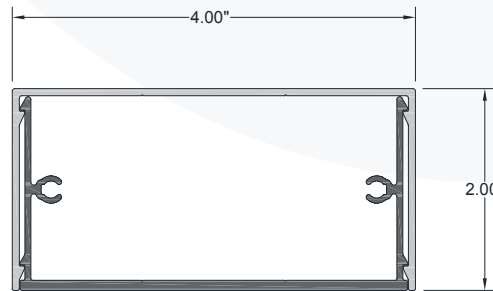

4" X 2" BATTEN ASSEMBLY

SYSTEM COMPONENTS

L-CONNECT ASSEMBLIES

The L-Connect Assembly is designed to allow fasteners to be installed through either side of the batten and concealed once assembled. This configuration provides secure attachment while maintaining a continuous exterior profile. The system supports flexible layout conditions without requiring exposed fasteners.

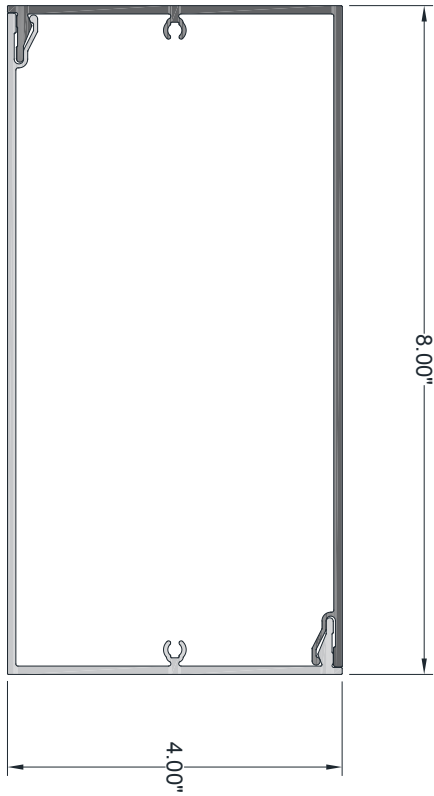

4" X 8"
L-CONNECT ASSEMBLY

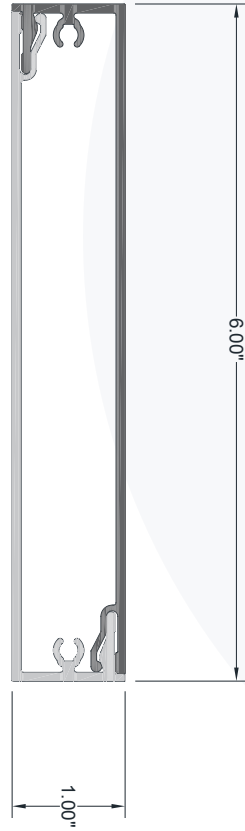

1" X 6"
L-CONNECT ASSEMBLY



1" X 5"
L-CONNECT ASSEMBLY

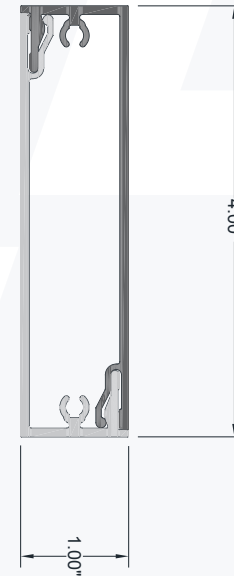

1" X 4"
L-CONNECT ASSEMBLY

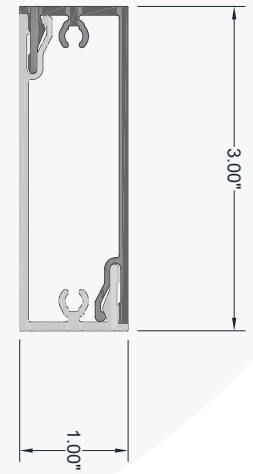

1" X 3"
L-CONNECT ASSEMBLY

SYSTEM COMPONENTS

EXPOSED BRACKETS

Exposed brackets are powder-coated aluminum components designed to remain visible as part of the finished installation. Brackets are fastened directly to the substrate, with battens secured to the brackets during installation. Slotted holes in the bracket allow for thermal expansion and adjustment while maintaining consistent alignment.

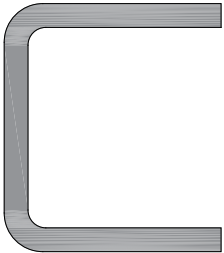

1" U BRACKET

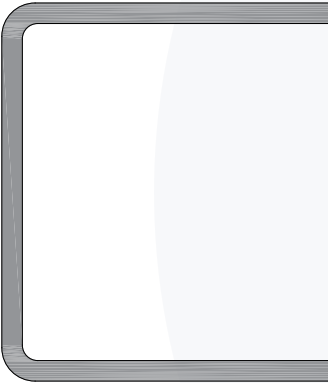

2" U BRACKET

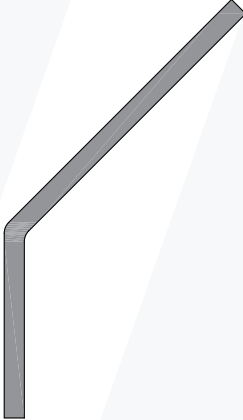

ANGLE BRACKET



L BRACKET

PREPARATION OF MATERIALS FOR INSTALLATION



It is recommended that a fresh, square cut is made on each end of the batten due to the manufacturing process.

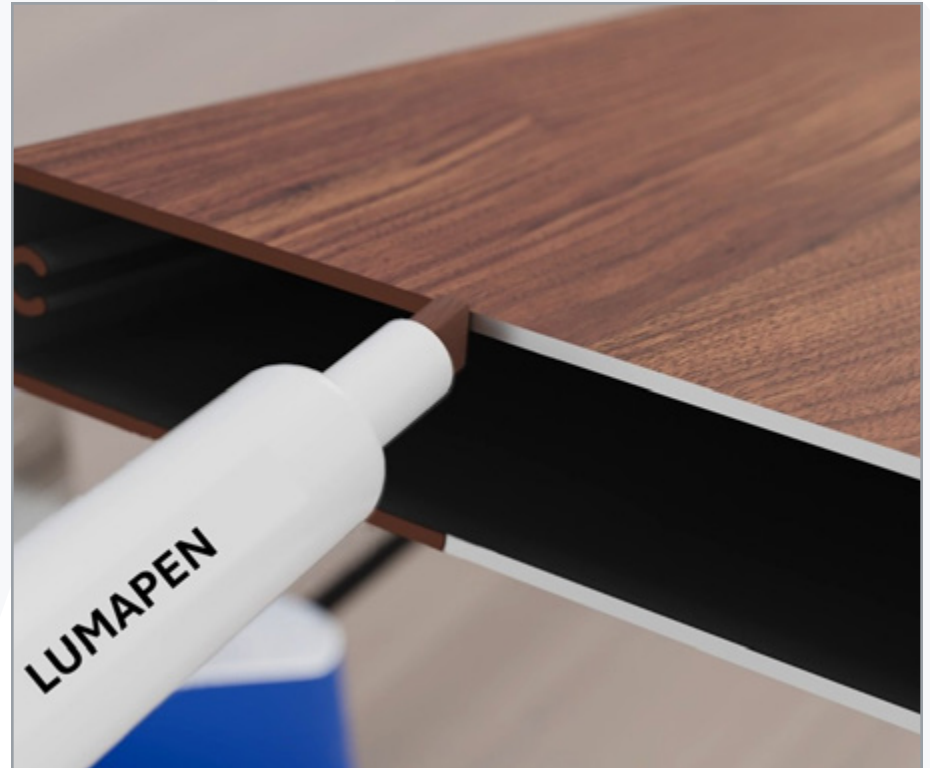

Utilize our touch-up pens to cover the exposed bare aluminum on the edges to help ensure a clean final look.

INSTALLATION UTILIZING EXPOSED BRACKETS ON SIDE OF BATTEN

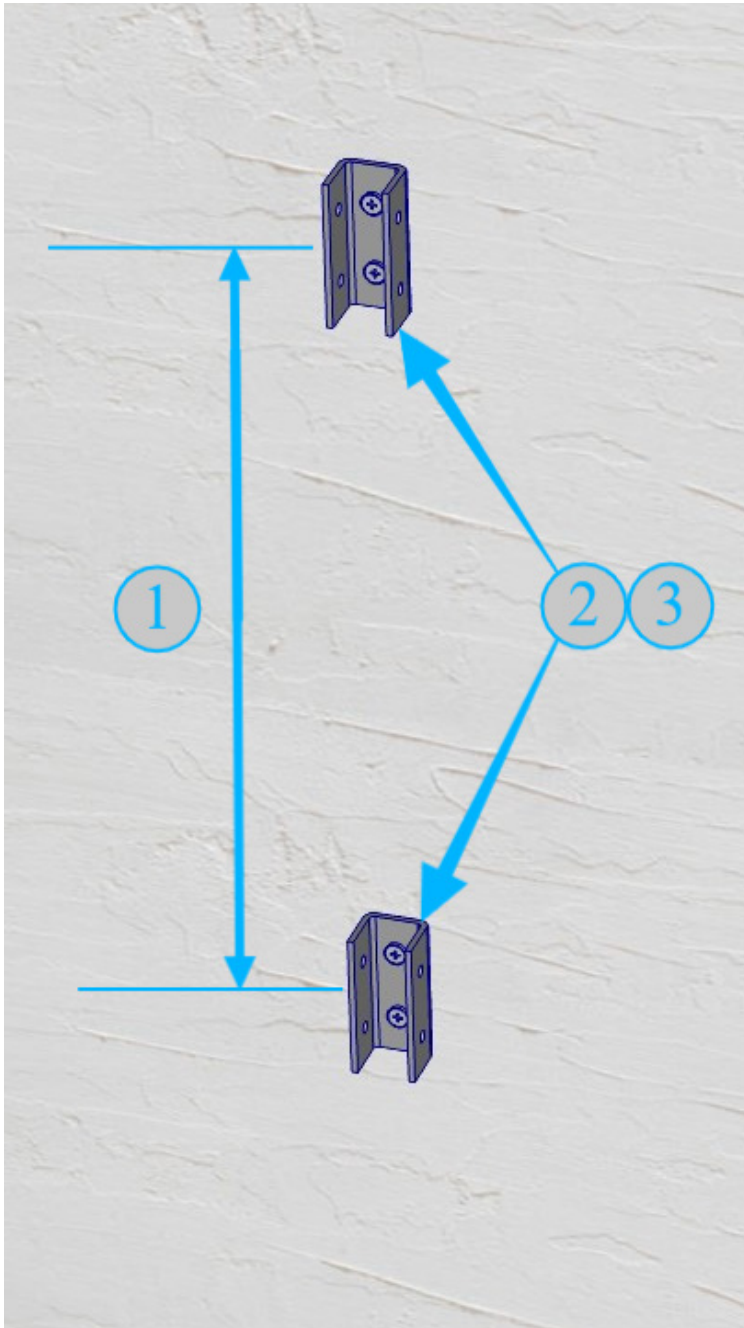

1. Determine anchorage spacing.

Reference the span tables (available at lumabuilt.com) and confirming requirements with the project engineer.

2. Use a #12-24 fastener.

Unless otherwise specified by the Engineer of Record.

3. Align brackets to receive the batten.

Then, fasten each bracket to the substrate by driving fasteners through the pre-drilled holes and into the cladding framing.

INSTALLATION UTILIZING EXPOSED BRACKETS ON SIDE OF BATTEN

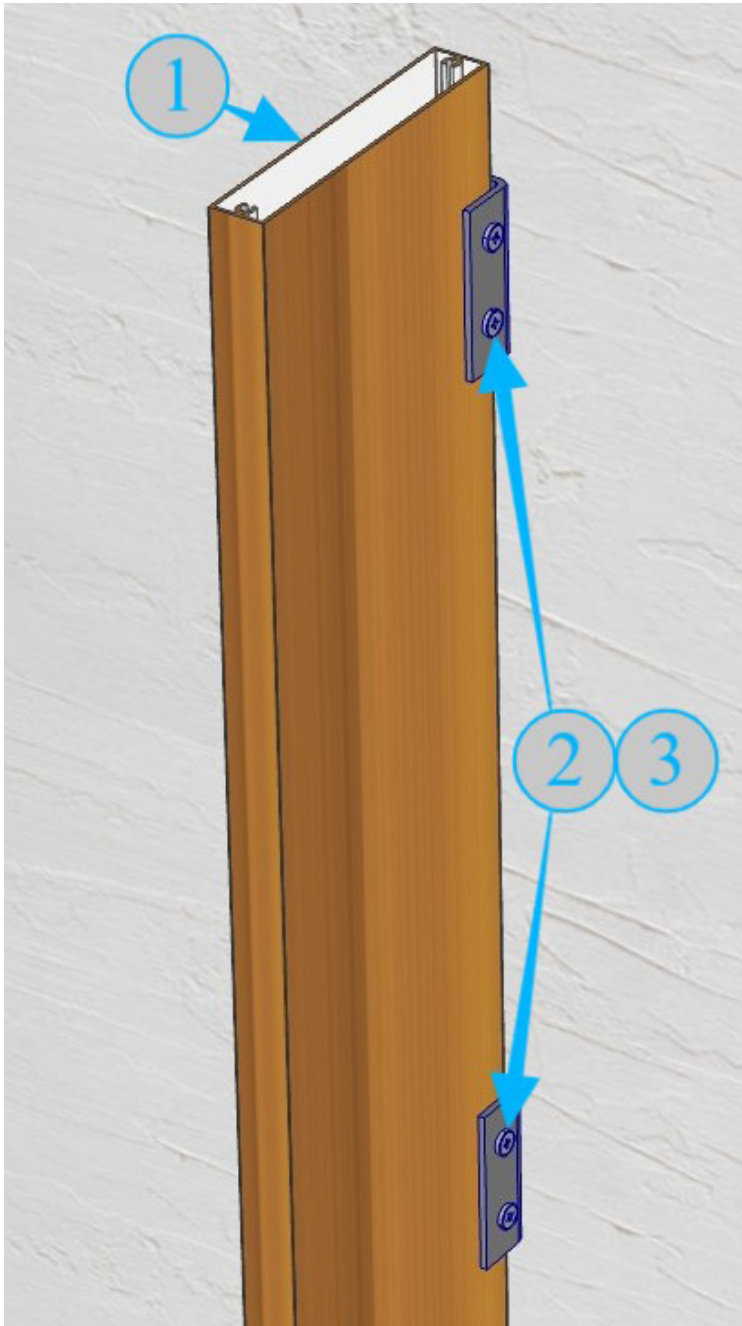

- 1. Insert the batten into the installed brackets.**
Ensure proper alignment and positioning.
- 2. Use a #12-24 fastener.**
Unless otherwise specified by the Engineer of Record.
- 3. Secure the batten to the brackets.**
Drive fasteners through the pre-drilled bracket holes and into the batten.

See page 16, for end cap installation procedures.

INSTALLATION UTILIZING EXPOSED BRACKETS ON ENDS OF BATTEN

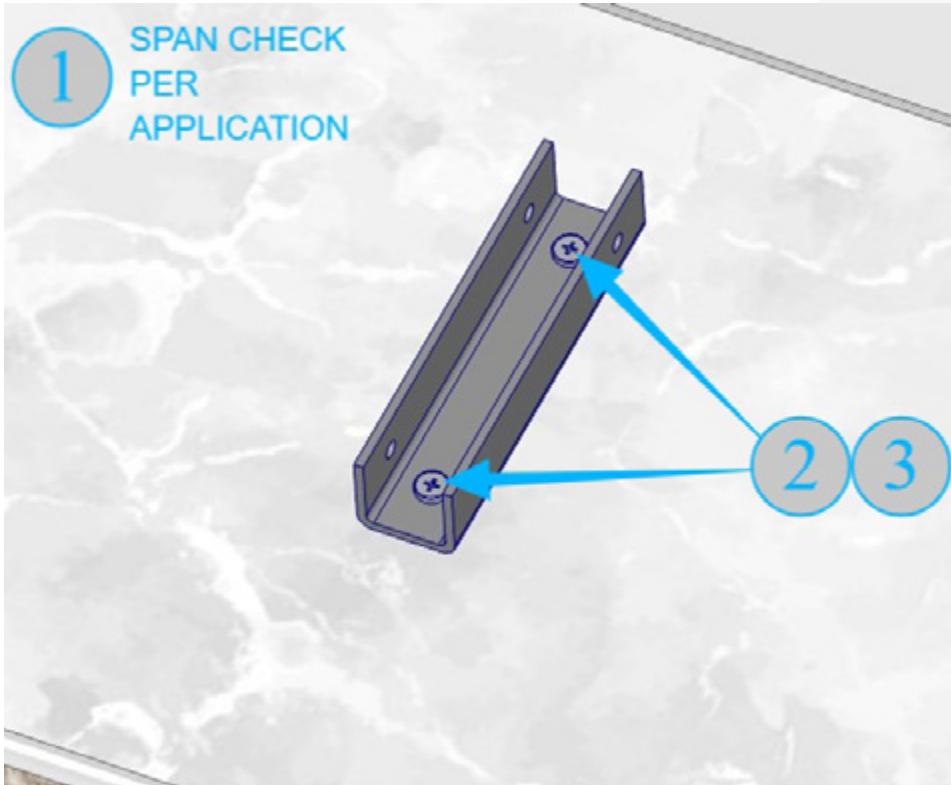

- 1. Determine anchorage spacing.**
Reference the span tables (available at lumabuilt.com) and confirming requirements with the project engineer.
- 2. Use a #12-24 fastener.**
Unless otherwise specified by the Engineer of Record.
- 3. Align brackets to receive the batten.**
Then, fasten each bracket to the substrate by driving fasteners through the pre-drilled holes and into the cladding framing.

INSTALLATION UTILIZING EXPOSED BRACKETS ON ENDS OF BATTEN

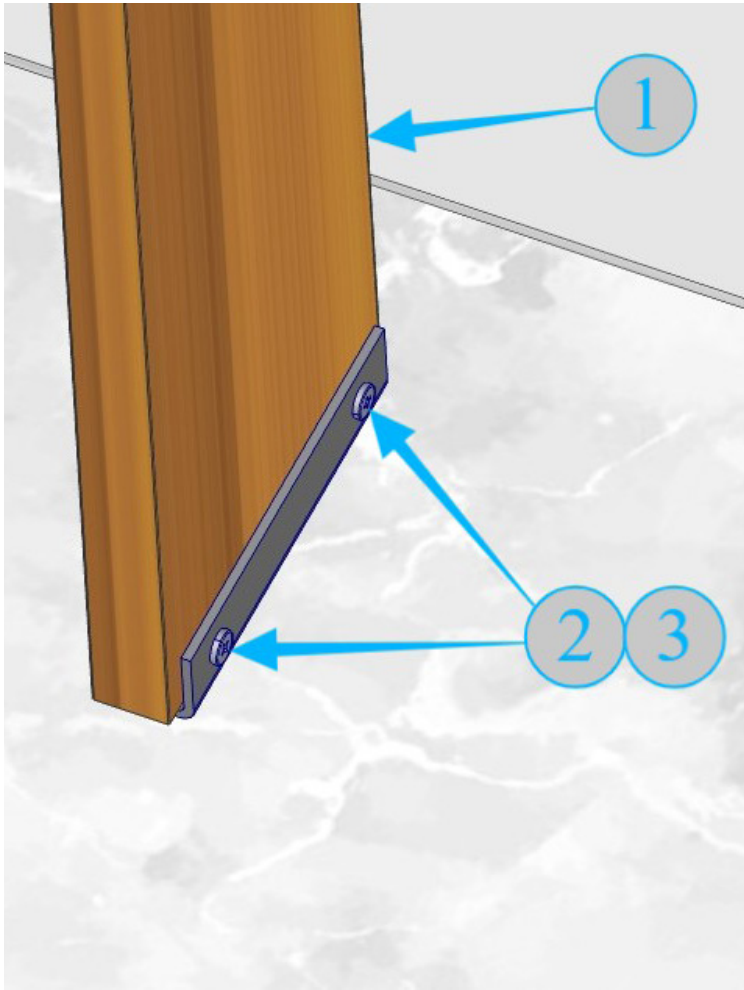

- 1. Insert the batten into the installed brackets.**
Ensure proper alignment and positioning.
- 2. Use a #12-24 fastener.**
Unless otherwise specified by the Engineer of Record.
- 3. Secure the batten to the brackets.**
Drive fasteners through the pre-drilled bracket holes and into the batten.

See page 16, for end cap installation procedures.

INSTALLATION OF BATTEN ASSEMBLIES

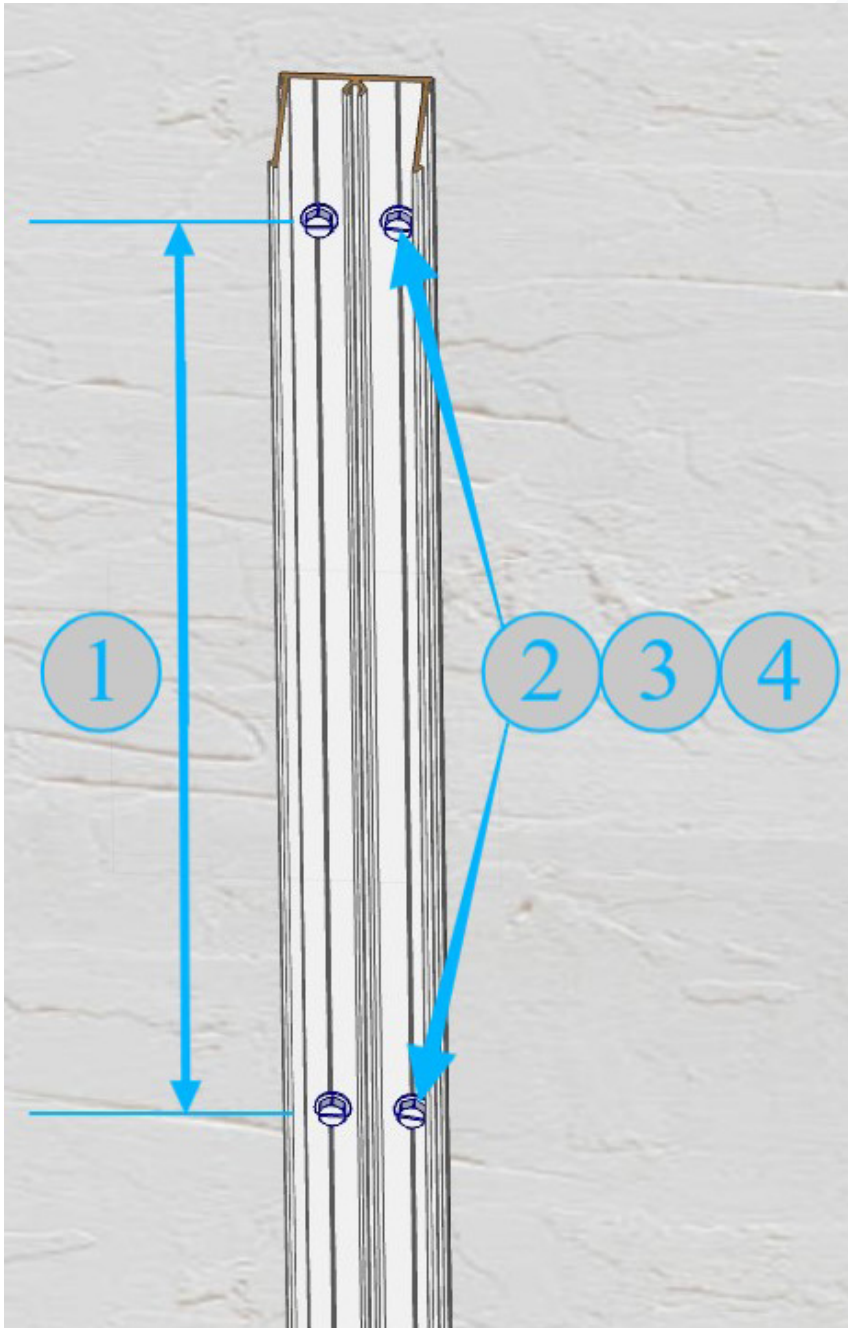

1. **Determine anchorage spacing.**

Reference the span tables (available at lumabuilt.com) and confirming requirements with the project engineer.

2. **Use a #12-24 fastener.**

Unless otherwise specified, and account for thermal movement at each anchorage location.

3. **Pre-drill holes through the batten base.**

At each anchorage point, use two fasteners per location.

4. **Secure the batten.**

Drive fasteners through the pre-drilled holes and into the cladding framing.

INSTALLATION OF BATTEN ASSEMBLIES

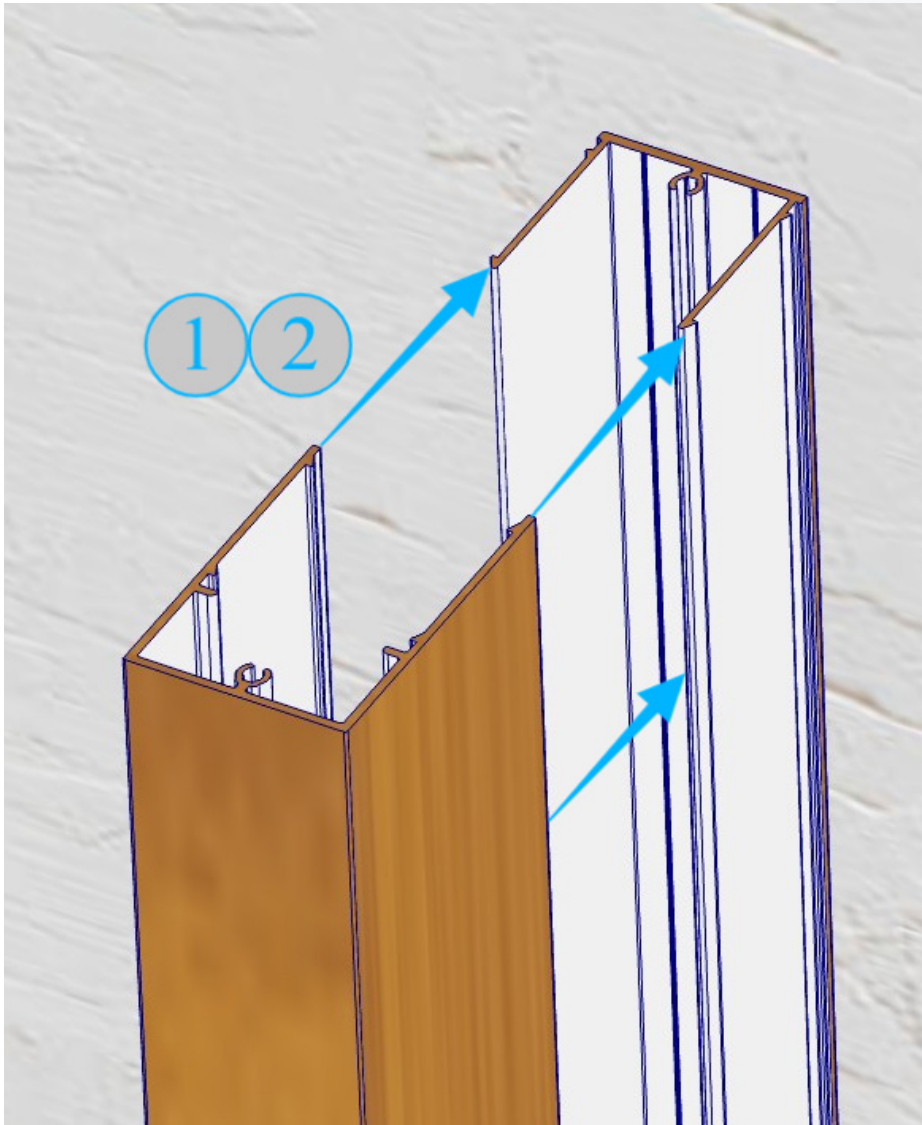

- 1. Align the batten cap with the batten base.**

Ensure the ends of the batten are flush.

- 2. Interlock the batten cap onto the batten base.**

- **Closed framing:** Start at one end of the batten and use a block and rubber mallet to tap the cap onto the base along the full length.

- **Open framing:** Start at one end of the batten and use clamps with rubber pads to secure the cap to the base along the full length until fully interlocked.

INSTALLATION OF BATTEN ASSEMBLIES

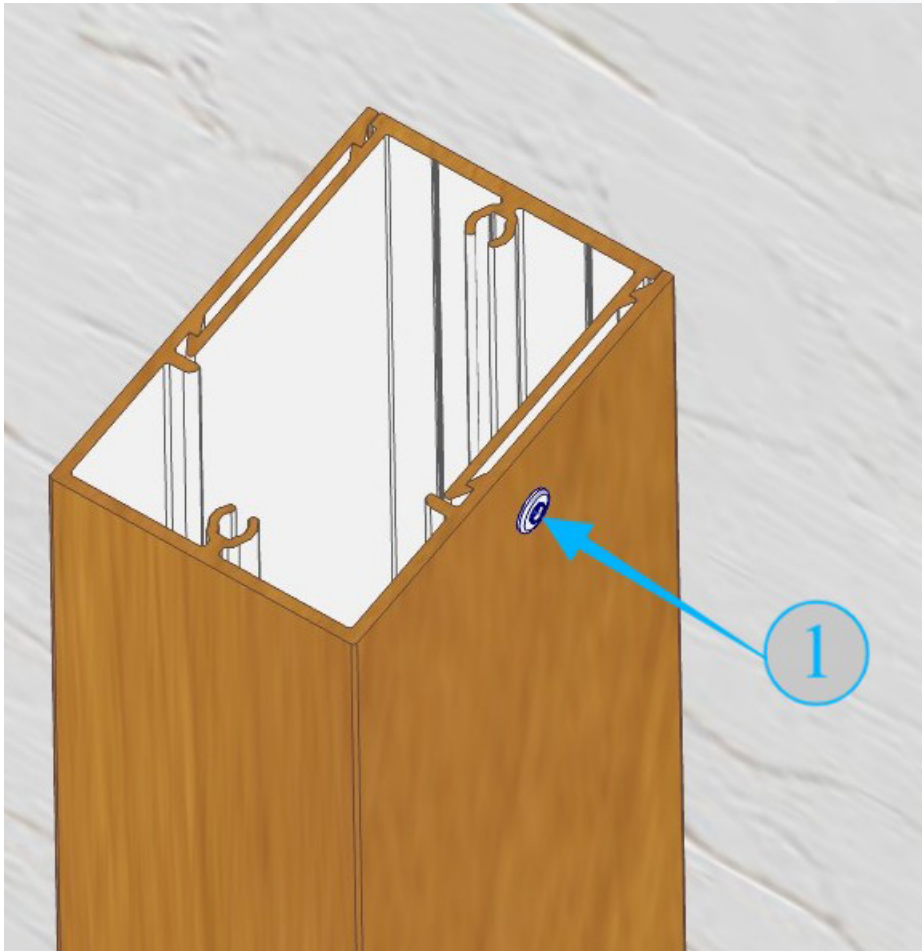

- 1. Install a 1/8" diameter stainless steel rivet.**
Place at one end of the batten to secure the components together. For vertical installations, place the rivet at the top end of the batten.

See page 16, for end cap installation procedures.

INSTALLATION OF L-CONNECT ASSEMBLIES

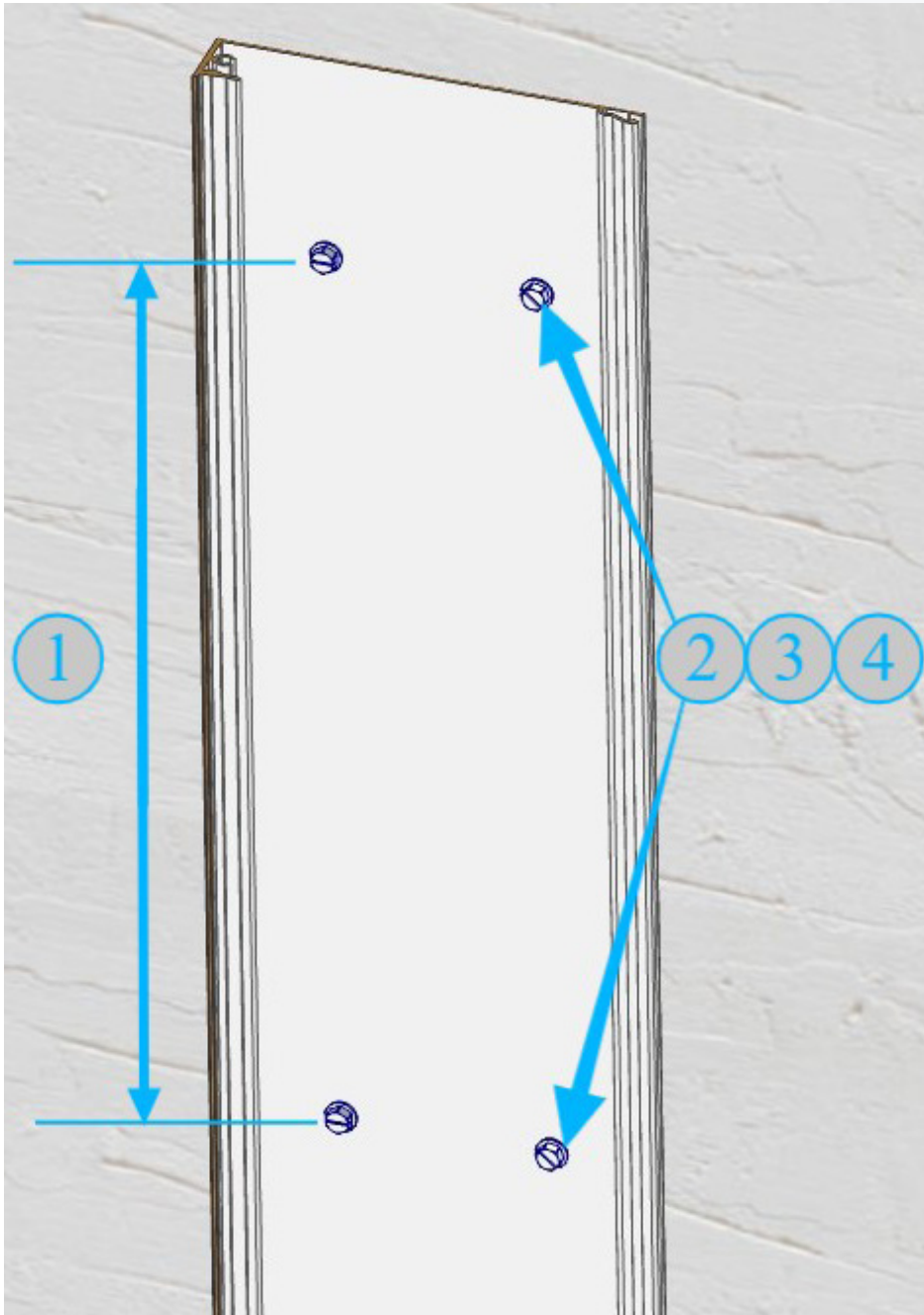

- 1. Determine anchorage spacing.**
Reference the span tables (available at lumabuilt.com) and confirming requirements with the project engineer.
- 2. Use a #12-24 fastener.**
unless otherwise specified, and account for thermal movement at each anchorage location.
- 3. Pre-drill holes through the batten base.**
At each anchorage point, use two fasteners per location.
- 4. Secure the batten.**
Drive fasteners through the pre-drilled holes and into the cladding framing.

INSTALLATION OF L-CONNECT ASSEMBLIES

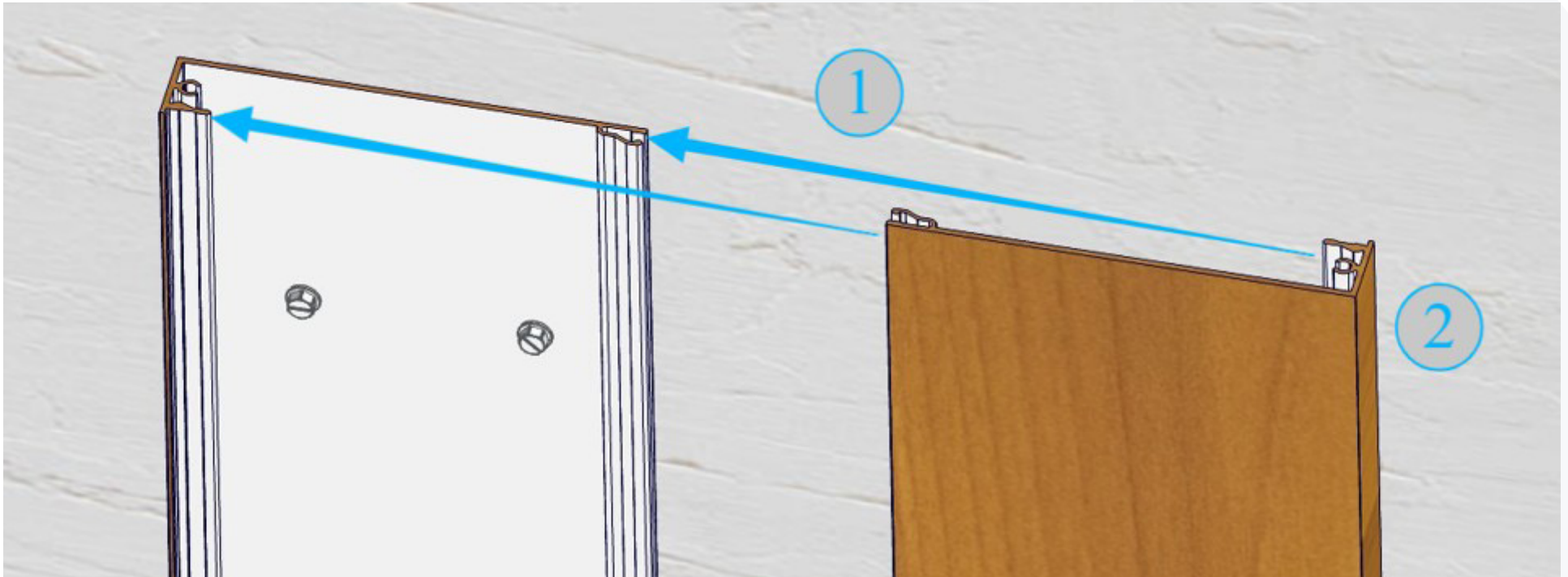

1. Align the L-Connect batten components

Ensure the ends of the batten are flush.

2. Interlock both L-Connect components together.

- **Closed framing:** Start at one end of the batten and use a block and rubber mallet to tap the cap onto the base along the full length.
- **Open framing:** Start at one end of the batten and use clamps with rubber pads to secure the cap to the base along the full length until fully interlocked.

INSTALLATION OF L-CONNECT ASSEMBLIES

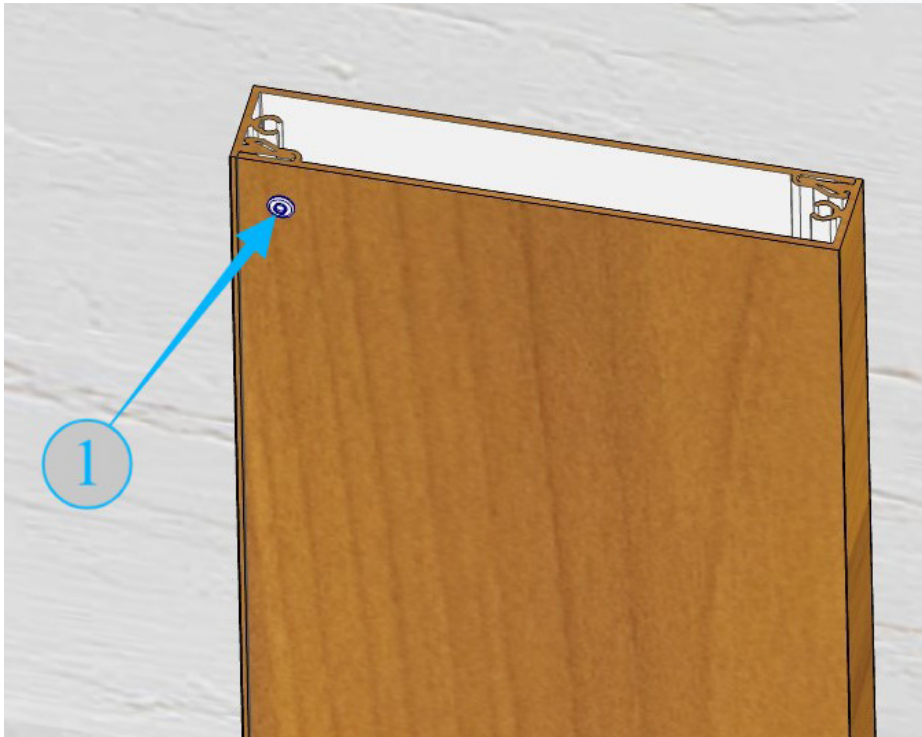

- 1. Install a 1/8" diameter stainless steel rivet.**
Place at one end of the batten to secure the components together. For vertical installations, place the rivet at the top end of the batten.

See page 16, for end cap installation procedures.

INSTALLATION WITH EXPOSED FASTENER INTERNAL BRACKET

This installation method can only be used with 2" x 2", 2" x 3", and 2" x 4" Batten Assemblies.

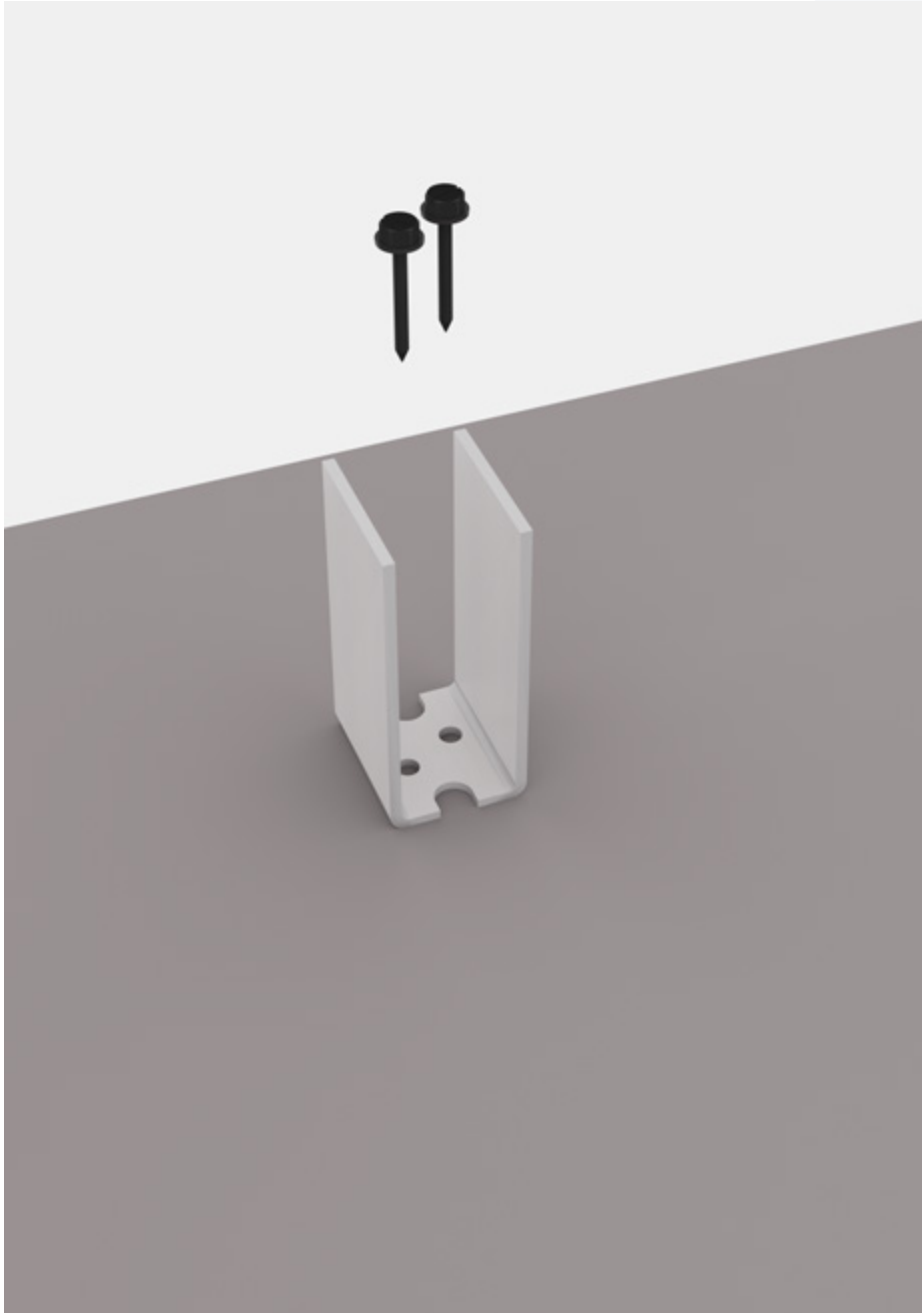

Install Internal Brackets.

Align internal brackets to layout and secure to the substrate using appropriately sized fasteners. Brackets may be oriented to accommodate vertical or horizontal batten installations.

INSTALLATION WITH EXPOSED FASTENER INTERNAL BRACKET

This installation method can only be used with 2" x 2", 2" x 3", and 2" x 4" Batten Assemblies.



Assemble Batten Profile.

Position the batten base over one side of the internal bracket, then interlock the batten cap with the base to fully enclose the bracket.

INSTALLATION WITH EXPOSED FASTENER INTERNAL BRACKET

This installation method can only be used with 2" x 2", 2" x 3", and 2" x 4" Batten Assemblies.

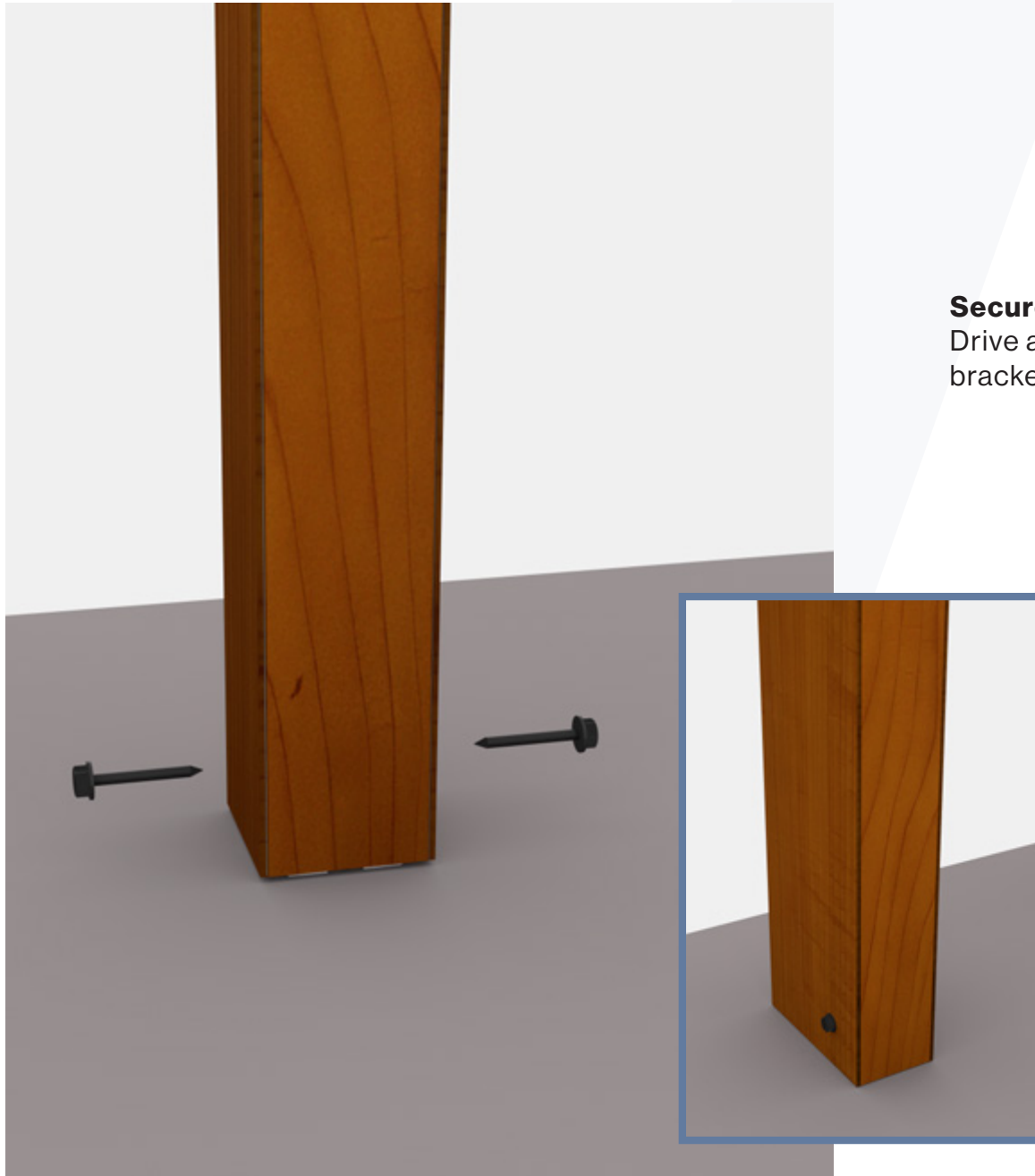

Secure Batten Assembly.

Drive a fastener through the batten wall and internal bracket to complete the installation.

INSTALLATION WITH HIDDEN FASTENER INTERNAL BRACKET

This installation method can only be used with 2" x 6" and 2" x 8" Batten Assemblies.

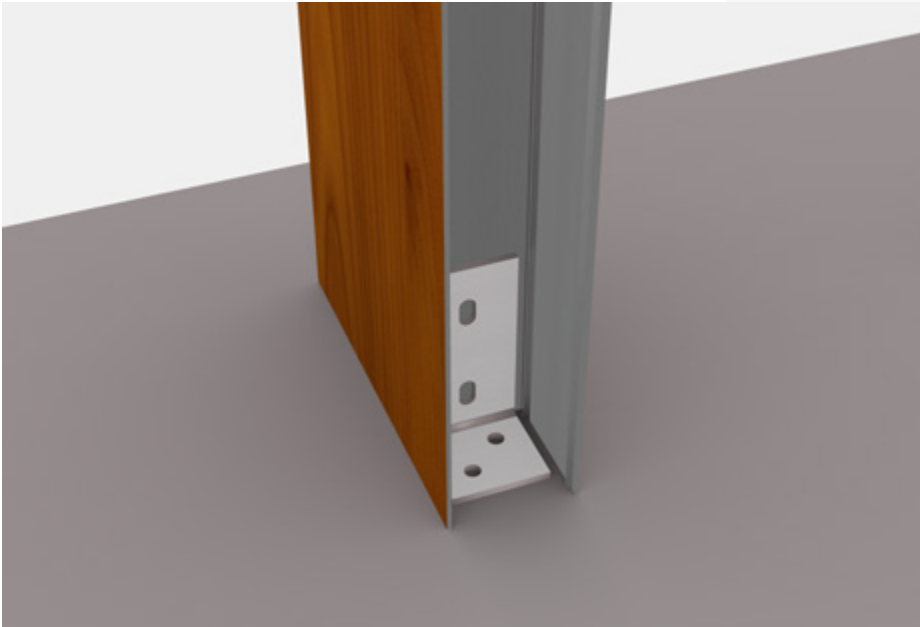

Align Internal Brackets

Use the batten cap as a guide to align internal brackets, ensuring proper spacing and centering. Secure top and bottom brackets to the substrate using appropriately sized fasteners. Brackets may also be oriented for horizontal batten installations.

INSTALLATION WITH HIDDEN FASTENER INTERNAL BRACKET

This installation method can only be used with 2" x 6" and 2" x 8" Batten Assemblies.



Attach Batten Cap

Position the batten cap against the internal bracket, confirming the bracket is centered within the profile. Drive fasteners through the bracket's slotted holes into the batten's internal wall.

INSTALLATION WITH HIDDEN FASTENER INTERNAL BRACKET

This installation method can only be used with 2" x 6", and 2" x 8" Batten Assemblies.



Complete Batten Assembly

Interlock the mating batten base with the cap to fully enclose the internal bracket and complete the installation.

END CAP INSTALLATION

- Plan your layout to ensure proper access for installing end caps. The end of the batten must remain unobstructed; if installation occurs close to an adjacent surface, install end caps before mounting the batten base.
- Position the batten 1/8" short of the intended finished length to accommodate the end cap.
- For two-piece battens, verify that both the base and cap are cut square and to identical lengths before installing the end cap.



T End Caps

- Place a small drop of clear silicone into each screw-boss location before installing the cap.
- Insert the pre-cut end cap and tap gently with a rubber mallet until fully seated and flush.
- The friction-fit design provides a secure, finished appearance with no exposed fasteners.



Flat End Caps

- Lightly crimp the screw-boss area to improve rivet grip and apply a small amount of clear silicone to each screw-boss location prior to installation.
- Insert the pre-punched end cap, then fasten using 1/8" aluminum or stainless-steel rivets.
- Install rivets in all provided holes to complete attachment.
- As an alternative, a #10 screw may be used.

**We are more than a manufacturer,
we are your partner in design,
every step of the way.**



2529 West Jackson Street
Phoenix, AZ 85009

602.275.1676

info@lumabuilt.com

For more information, visit lumabuilt.com